



Trimble Earthworks
Grade Control Platform
for Excavators



80% of construction jobs run into overtime...

Introducing **Undertime**

Ask for the next generation of machine control. From the company that invented machine control.

The **Trimble® Earthworks Grade Control Platform for Excavators** is designed to help you do more in less time. Reengineered from the ground up, our innovative, next generation grade control platform features intuitive, easy-to-learn software that runs on an Android™ operating system. And state-of-the-art software and hardware give operators of all skill levels the ability to work faster and more productively than ever before.

Now available in a subscription model with flexible terms to modernize your equipment with no large upfront cost.

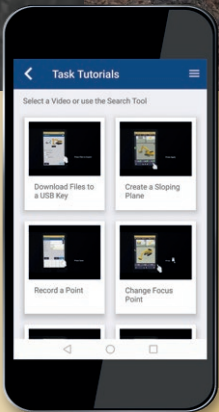

Download the **Trimble Earthworks Assistant** app to easily access consolidated Trimble Earthworks learning material and documentation, allowing for a shorter learning curve and less downtime.

The Trimble Earthworks Assistant app makes it easy to learn and troubleshoot using an Android cell phone, even from remote sites.

Available on the Google Play Store



INTUITIVE SOFTWARE, RUGGED HARDWARE

The Trimble Earthworks Software runs on the 10-inch (25.4 cm) Trimble TD520 display or the 7-inch (17.8 cm) Trimble TD510 display. Colorful graphics, natural interactions and gestures, and self-discovery features make Trimble Earthworks intuitive and easy to learn. Each operator can personalize the interface to match their workflow and a variety of configurable views make it easier to see the right perspective for maximum productivity.

To ensure everyone is operating from the latest design, transfer data files to or from the office wirelessly and automatically using Trimble WorksManager, mobile-friendly software that easily manages data and technology assets across project sites.



EXCAVATOR AUTOMATICS

With Trimble Earthworks, you can now take advantage of the first integrated 3D aftermarket grade control automatics for excavators and tilt-rotator attachments. Excavators can work semi-automatically, allowing operators to create smooth, flat or sloped surfaces more easily.

How it works:

1. The excavator is placed in Autos mode
2. The operator controls the stick
3. Trimble Earthworks controls the boom and bucket
4. Stay on grade, reduce overcut and increase production

Achieve grade consistently, with high accuracy and in less time by automating excavator operation with Trimble Earthworks.

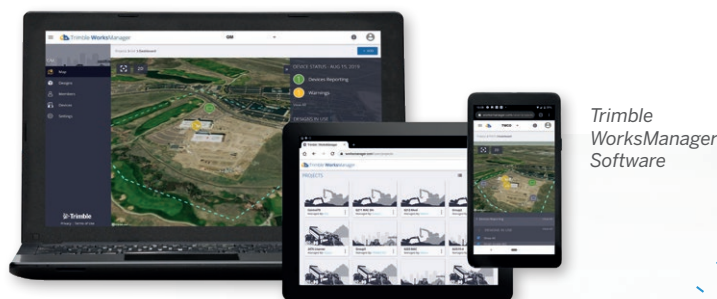

AUGMENTED REALITY

Using a camera mounted on the outside of the machine, operators can now view 3D models in a real-world environment at a true-life scale, in the context of existing surroundings. On the Trimble Earthworks display, the model is overlaid onto existing ground giving the operator a better understanding of the work that needs to be done. Visibility of the bucket gives operators better situational awareness to be able to keep surrounding people and objects safe.

Augmented reality for excavators enables users to easily understand 3D models, cut/fill information, slope data and other bench points and reference points in context, without the need to interpret complex 2D plans or stakes.

PAYLOAD MANAGEMENT INTEGRATION

Upgrade your Trimble Earthworks Grade Control Platform with Trimble LOADRITE® Payload Management for increased mass haul productivity and efficiency. Track bucket-by-bucket payload and monitor mass haul progress from the same powerful Trimble Earthworks TD520 display, prevent underloading and improve safety by avoiding overloading.





Trimble Earthworks: Excavator Configuration Options

Core System

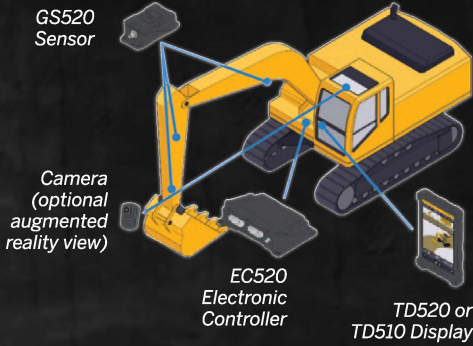

Automatics System

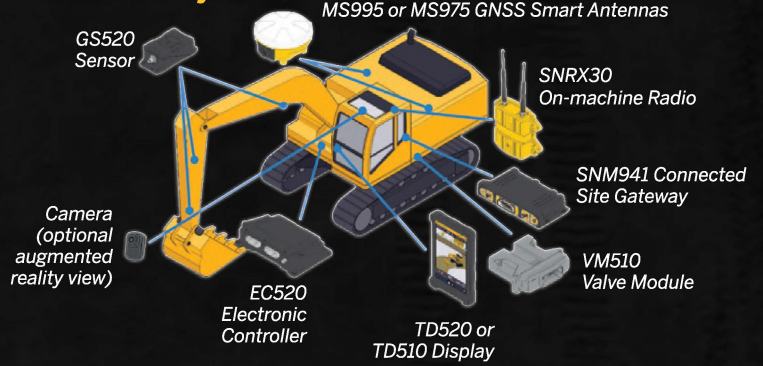

Dual/Single GNSS Systems

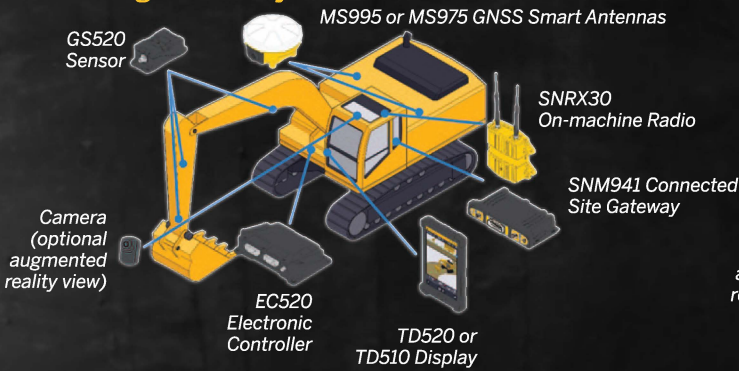

Universal Total Station System

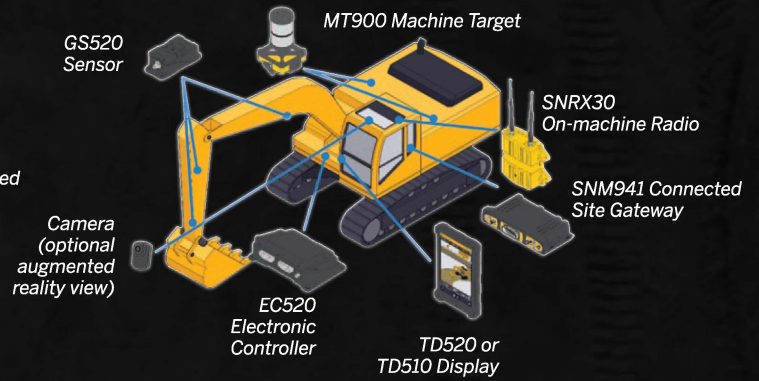

Upgraded AS450 Sensor-based Trimble GCS900 Grade Control Systems are only supported in Trimble Earthworks v1.11.X and prior



Spektra a Trimble Company
Via Pellizzari 23/A, 20871 Vimercate (MB)
Tel. +39 039 625051
www.spektra.it | info@spektra.it